

This webpage is using significant energy. Closing it may improve the responsiveness of your Mac.

A co.hittitas.wa.us



Washington State
Department of Transportation
Douglas B. MacDonald
Secretary of Transportation

South Central Region
2809 Rudden Road, Union Gap
P.O. Box 12560
TAMMUN, WA 98499-2560
509-577-4890
TTY: 1-800-833-8388
www.wasdot.wa.gov

March 4, 2003

Ronald Millste 3
PO Box 357
Roslyn, WA 98941

RE: Access Connection Permit 3623
SR 903, MP 8.110 Right

Dear Mr. Ragland,

We are in receipt of the certificate of deposit and the signed copies of the permit. Enclosed, please find your copy of the fully executed Access Connection Permit for a single Category 2 commercial approach not to exceed 30 feet in width. As noted in the permit, the approach is to be constructed per the attached exhibits. Per the Special Provisions, you are required to contact Mr. Terry Kukes, our Area 1 Maintenance superintendent, prior to beginning work. He can be reached at 509-577-1907.

If you have any questions or require further information, feel free to contact Rick Holmstrom at (509) 577-1633.

Sincerely,

Troy A. Stuing, P.E.
Regional Planning Engineer

TAS:stw
Enclosures

cc: Terry Kukes - Area 1 Maintenance Superintendent

file: p:\planning\access\2003\3623\permit.doc

RECEIVED
APR 24 2010

Kitittas Co. CDS

Screen Shot
2018-04...27 ST PM
West Int...mate.pdf

071341DW 2 Plan
Set.pdf

UCB 1822 -
Internal...3.08 PDF

Palentino Major
plat Ph...an D1.pdf

This webpage is using significant energy. Closing it may improve the responsiveness of your Mac.

A coakhtzaswau

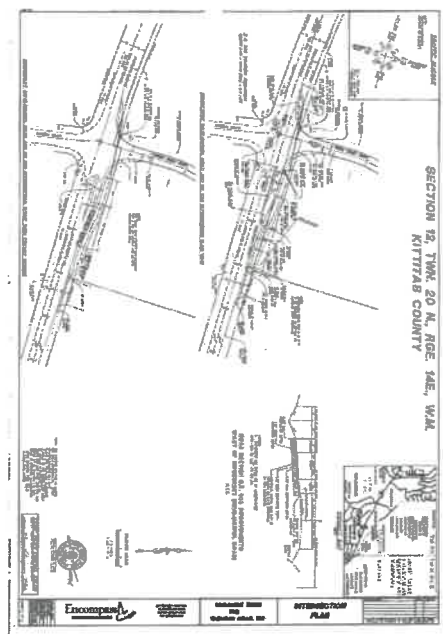

EVG PUD Parcel B
DW 2 pla...318.xlsx

Screen Shot
2018-04...013 AM

Screen Shot
2018-04...3 AM (2)

Screen Shot
2018-04...9 PM (2)